

MASTER PART MARK	VIN	AVAILABLE THICKNESS	YIELD MIN.	BLANK LENGTH	BLANK WIDTH	WEIGHT (LBS)
SSCH	B	0.060	50 KSI	6.00	4.50	0.46

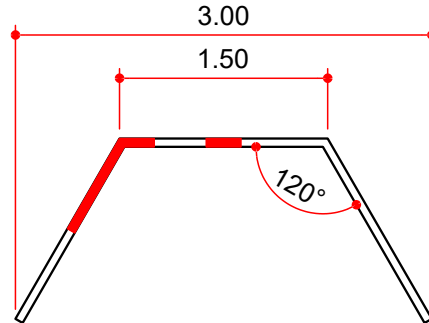

**SECTION A**

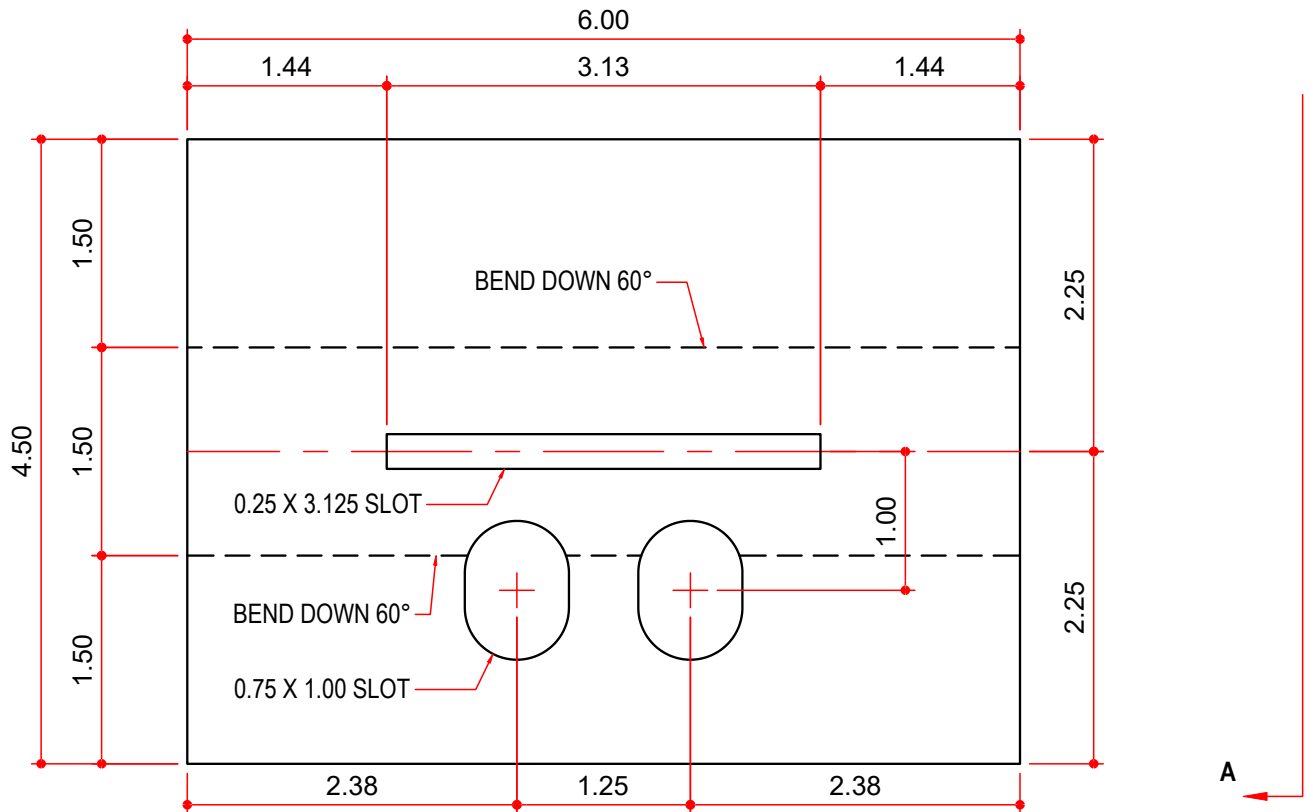

**FRONT VIEW**

**NOTES: BUYOUT**

- 1) CLIP HOOD IS USED WITH SSII PANEL CLIPS TO CREATE REINFORCED CLIPS WHEN REQUIRED BY DESIGN.
- 2) CLIP HOOD IS SHIPPED LOOSE BY SUPPLIER TO NBG.
- 3) CLIP HOOD IS SHIPPED LOOSE BY NBG AND ASSEMBLED TO THE SSII PANEL CLIPS (SSPC-1 OR SSPC-2T) IN THE FIELD.
- 4) NOTE THIS IS THE SAME HOOD THAT COMES PRE-ASSEMBLED, FROM THE SUPPLIER, ON THE SS360 REINFORCED CLIPS.

**AVAILABLE COLORS**

NP