

MASTER PART MARK	VIN	AVAILABLE THICKNESS	YIELD MIN.	BLANK LENGTH	BLANK WIDTH	WEIGHT (LBS)
SCD121	A	24 OR 26 GA	33 KSI	121.00	9.00	6.02

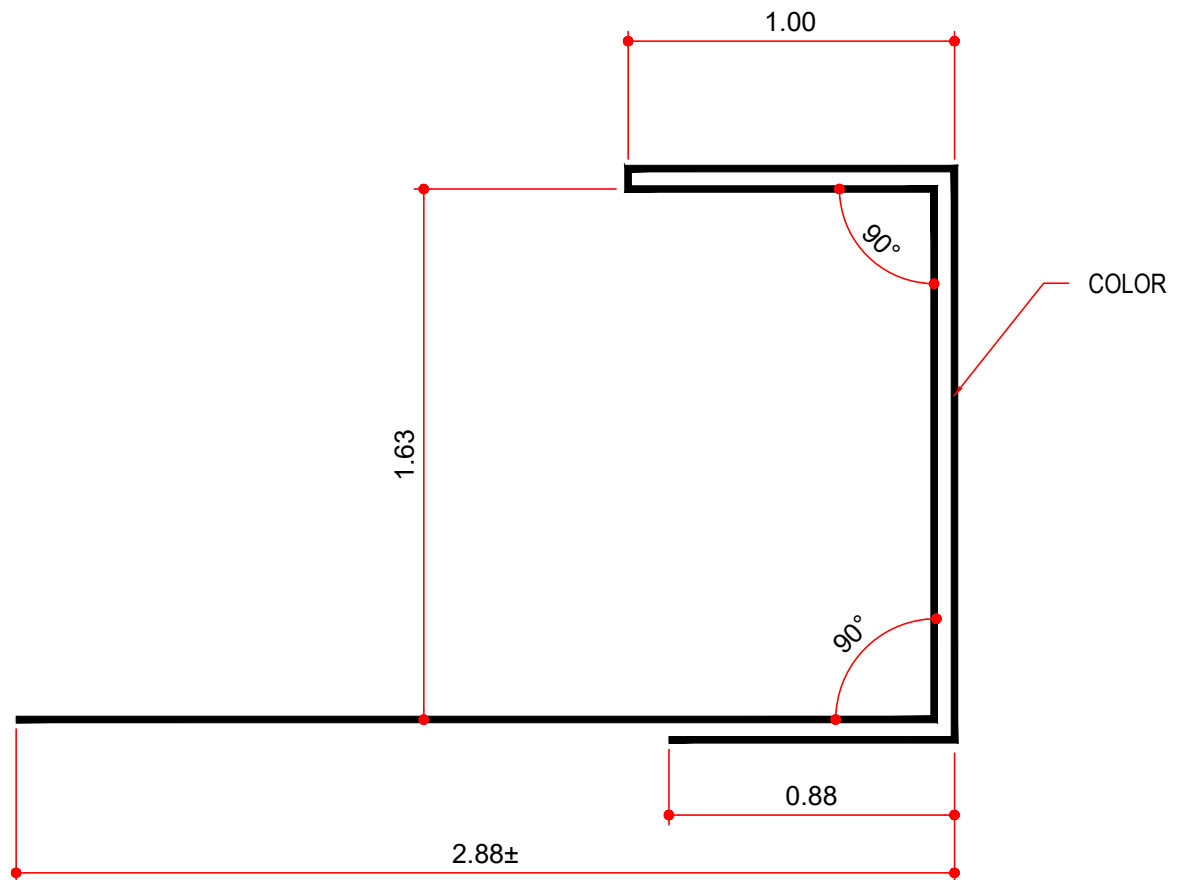

NOTES:

- 1) FOR USE WITH 1.5" DEEP PANEL
- 2) SHOP NOTE: IT IS ACCEPTABLE TO USE LONGER BLANK LENGTHS (122 & 124) IF PRE-CUT LENGTHS ARE STORED.
- 3) DETAILING NOTE: IF USING THIS PART OUTSIDE OF THE INTENDED DETAILS, CONSIDER USING HDD___ TRIM INSTEAD.

AVAILABLE COLORS

ALL STANDARD SMP & PVDF COLORS