

MASTER PART MARK	VIN	AVAILABLE THICKNESS	YIELD MIN.	BLANK LENGTH	BLANK WIDTH	WEIGHT (LBS)
DSP121	A	24 OR 26 GA	33 KSI	121.00	19.63	13.12

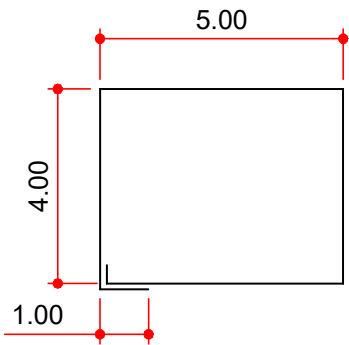

SECTION A
ALTERNATE #1

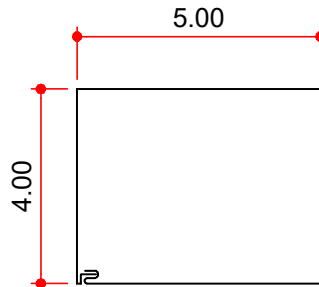

SECTION A

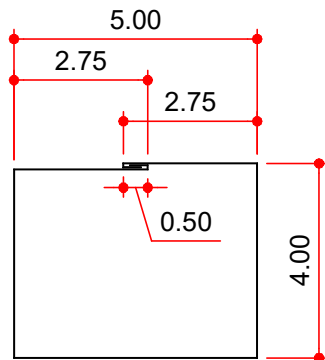

SECTION A
ALTERNATE #2

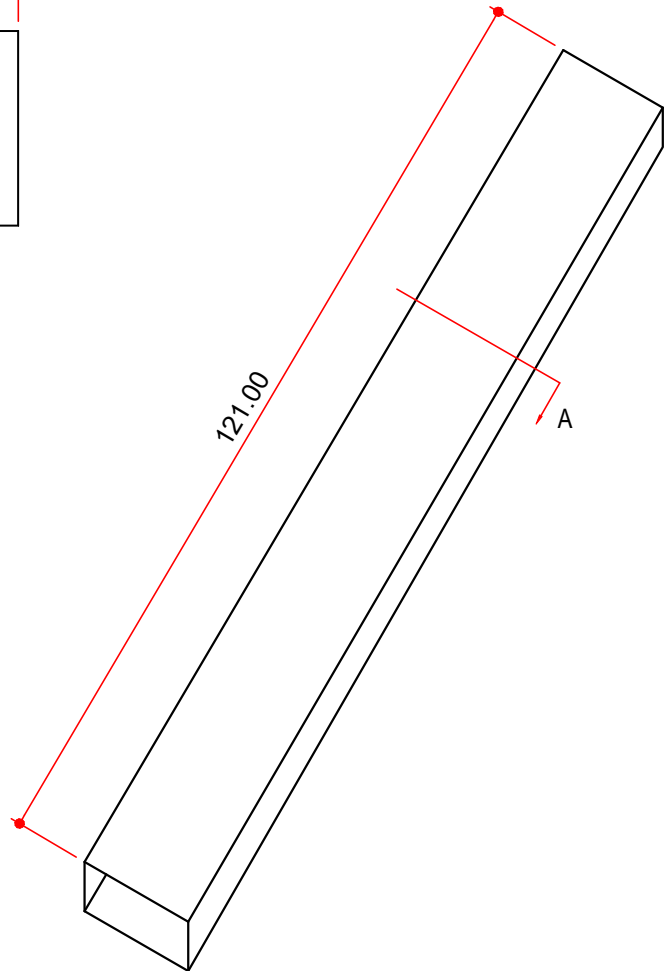

NOTES:

1) SHOP NOTE:

- ALTERNATE #1: FASTEN DOWNPOUT TOGETHER WITH (7) POP RIVETS (H1100) (SAME COLOR AS DOWNPOUT), (1) RIVET AT EACH END AND OTHERS 20" O.C.
- ALTERNATE #2: FASTEN DOWNPOUT TOGETHER WITH (3) POP RIVETS (H1100) (SAME COLOR AS DOWNPOUT), (1) RIVET AT EACH END AND (1) AT MID-SPAN THROUGH INTERLOCKING HEMS

AVAILABLE COLORS

ALL STANDARD SMP & PVDF COLORS